

**DIN 316**

**Wing screws**

Round wing shape (German form)

Steel Malleable cast iron | zinc-plated | Cr(VI)-free | Metric thread

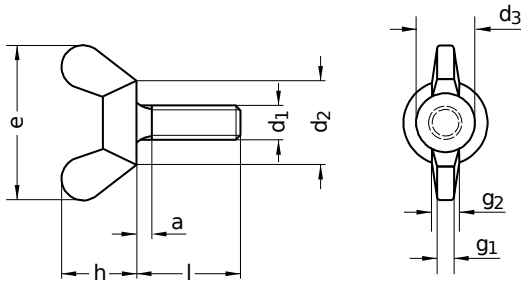

Diameter (d)	a	d <sub>1</sub>	d <sub>2</sub>		d <sub>3</sub>		e		g <sub>1</sub>		g <sub>2</sub>		h		m		Pitch (P)
	max.	nominal size	min.	max.	min.	max.	max.	min.	min.	max.	min.	max.	min.	max.	min.	max.	
M4	2.1	M 4	6	8	5.5	7.0	20	18	1.1	1.9	1.7	2.3	8.5	10.5	3.2	4.6	0.70
M5	2.4	M 5	8	11	7.5	9.0	26	24	1.5	2.3	2.3	2.8	11.0	13.0	4.0	6.5	0.80
M6	3.0	M 6	10	13	9.0	11.0	33	30	1.5	2.3	2.7	3.3	15.0	17.0	5.0	8.0	1.00
M8	4.0	M 8	13	16	10.5	12.5	39	36	2.0	2.8	3.6	4.4	18.0	20.0	6.5	10.0	1.25
M10	4.5	M 10	17	20	14.5	16.5	51	48	3.6	4.4	4.6	5.4	23.0	25.0	8.0	12.0	1.50
M12	5.3	M 12	20	23	17.5	19.5	65	62	4.1	4.9	5.6	6.4	31.0	33.5	10.0	14.0	1.75

Length (l) nominal size
10
12
16
20
25
30

Length (l) nominal size
35
40
50
60

Diameter (d)	Length (l)									
	10	12	16	20	25	30	35	40	50	60
M4	●	●	●							
M5	●	●		●	●	●				
M6	●	●	●	●	●	●	●	●		●
M8	●		●	●	●	●	●	●	●	●
M10			●	●	●	●		●	●	
M12			●		●	●		●		●

• Combinations available in the eShop | Other sizes on request

All technical data refer to the measure mm

