

**DIN 965** similar to ISO 7046

# Countersunk bolts

Cross-slot phillips

Stainless steel A2 | Cr(VI)-free | Metric thread

Further information: DIN standard has been withdrawn

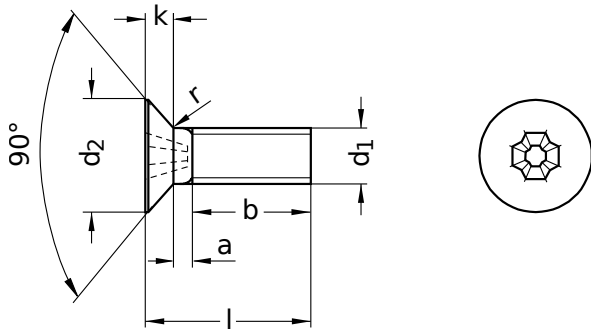

Diameter (d)	a max.	b nominal size	d <sub>1</sub> nominal size	d <sub>2</sub> nominal size	k max.	r max.	Pitch (P)	Tool size
M1.6	0.7	15	M1.6	3	0.96	0.4	–	H1
M2	0.8	16	M2	3.8	1.20	0.5	0.40	H1
M2			M2	3.8				
M2.5	0.9	18	M 2.5	4.7	1.50	0.7	0.45	H1
M2.5			M2.5	4.7				
M3	1.0	19	M3	5.6	1.65	0.8	0.50	H1
M3			M3	5.6				
M4	1.4	22	M4	7.5	2.20	1.0	0.70	H2
M5	1.6	25	M5	9.2	2.50	1.3	0.80	H2
M5			M5	9.2				
M6	2.0	28	M6	11	3.00	1.6	1.00	H3
M8	2.5	34	M8	14.5	4.00	2.0	1.25	H4
M8			M8	14.5				
M10	3.0	40	M10	18	5.00	2.5	1.50	H4

nominal size	Length (l)	
	min.	max.
2	1.75	2.25
3	2.75	3.25
4	3.75	4.25
5	4.75	5.25
6	5.75	6.25
8	7.70	8.30
10	9.70	10.30
12	11.65	12.35
14	13.65	14.35
16	15.65	16.35
18	17.65	18.35
20	19.60	20.40

nominal size	Length (l)	
	min.	max.
22	21.60	22.40
25	24.60	25.40
30	29.60	30.40
32	31.60	32.40
35	34.50	35.50
40	39.50	40.50
45	44.50	45.50
50	49.50	50.50
60	59.00	61.00
80	79.00	81.00

All technical data refer to the measure mm



**DIN 965** similar to ISO 7046

## Countersunk bolts

Cross-slot phillips

Stainless steel A2 | Cr(VI)-free | Metric thread

Diameter (d)	Length (l)																					
	2	3	4	5	6	8	10	12	14	16	18	20	22	25	30	32	35	40	45	50	60	80
M1.6	●		●					●														
M2		●	●	●	●	●	●	●		●		●										
M2.5		●	●	●	●	●	●	●		●		●										
M3			●	●	●	●	●	●	●	●	●	●	●	●	●							
M4				●	●	●	●	●	●	●	●	●	●	●	●		●	●				
M5				●	●	●	●	●	●	●		●	●	●	●	●	●	●	●	●	●	●
M6						●	●	●	●	●		●		●	●	●	●	●	●	●	●	●
M8								●		●		●		●	●	●	●	●	●	●	●	●
M10										●		●		●	●		●	●		●	●	

• Combinations available in the eShop | Other sizes on request

All technical data refer to the measure mm

